

**PORT TAMPA BAY
NOTICE OF PUBLIC HEARING**

Notice is hereby given of a public hearing to be held on October 22, 2024 at 10:00 a.m., before the Tampa Port Authority, d/b/a Port Tampa Bay at its offices located at 1101 Channelside Drive, Tampa, Florida 33602, to hear public comments regarding the following:

HONORABLE MARCO RUBIO – OFFICE LEASE AGREEMENT

Additional information is available online at www.tampaport.com. All written comments and objections directed toward the foregoing matter should be filed with Port Tampa Bay, Real Estate Department, at 1101 Channelside Drive, Tampa, Florida 33602 by 12:00 noon on October 21, 2024. Oral comments and objections may be presented at the hearing.

In accordance with the federal Americans with Disabilities Act and Section 286.26, Florida Statutes, persons with disabilities requiring reasonable accommodation to participate in this hearing should call (813) 905-5031 or fax (813) 905-5029 not later than 48 hours prior to the hearing.

ANY PERSON WHO DECIDES TO APPEAL ANY DECISION OF THE PORT TAMPA BAY WITH RESPECT TO ANY MATTER CONSIDERED AT THIS PUBLIC HEARING WILL NEED A RECORD OF THE PROCEEDINGS AND, FOR SUCH A PURPOSE, MAY NEED TO HIRE A COURT REPORTER TO ENSURE THAT A VERBATIM RECORD OF THE PROCEEDINGS IS MADE, WHICH RECORD INCLUDES THE TESTIMONY AND EVIDENCE UPON WHICH THE APPEAL IS TO BE BASED.

To be published on Sunday, September 15, 2024
In the Tampa Bay Times

BACKGROUND INFORMATION FOR PUBLIC HEARING
October 18, 2024 AT 10:00 A.M.

HONORABLE MARCO RUBIO
OFFICE LEASE AGREEMENT

Honorable Marco Rubio has served as a United States Senator representing Florida since 2011. Senator Rubio is interested in leasing office space from the Tampa Port Authority, d/b/a Port Tampa Bay, within the Joseph Garcia International Center located at 1101 Channelside Drive, Tampa, Florida 33602.

Port Tampa Bay and Senator Rubio have agreed to the following terms:

- Premises:** Approximately 544 square feet of office space located on the second floor of the Joseph Garcia International Center as outlined on the "Exhibit A".
- Use:** General and executive offices only.
- Term:** Three (3) years, ten (10) months and two (2) days with no Lease Extension Options.
- Rent:** Annual Rent for the Premises will be as follows:
- Base Rent: \$1,360.00 monthly or \$16,320.00 annually
- Amortized Improvements: \$609.03 monthly or \$7,308.36 annually
- Total Rent: \$1,969.03 monthly or \$23,628.36 annually
- Tenant Improvement:** Port Tampa Bay shall be responsible for the cost of performing the Tenant Work up to a maximum cost of \$28,015.51. The amortized amount will be reimbursed in equal monthly installments during the term of the lease.
- Other:** Honorable Marco Rubio would be responsible for telephone and data services, and insurance requirement of Port Tampa Bay. Port Tampa Bay would provide janitorial service, electrical and water/sewer service, and maintenance of building common areas.

Exhibit "A"

PREMISES

PROPERTY OF THE UNITED STATES GOVERNMENT - FOR OFFICIAL USE ONLY
Do not remove this notice - Properly destroy documents when no longer needed

Senator Rubio
Port of Tampa Bay Headquarters
1101 Channelside Drive
Suite 213, 214, 215, 215B & 216
Tampa, FL
33602

United States Senate
Sergeant at Arms



State Office Security

REVISIONS				
NO	DATE	BY	DESCRIPTION	
E	05/31/24	JJB	update per Design Meeting 1	
D	04/09/24	JJB	update GC per Gary Roberts	
C	03/27/24	JJB	add outlets per Scott Carroll	
B	03/25/24	JJB	update suite and security	
A	03/14/24	JJB	add suite 213 per Scott Carroll	
Drawn by <u>John J. Brennan</u> Checked by _____				
Approved by _____ Date <u>03/14/24</u>				

TITLE:
Tampa Bay Office

GENERAL CONTRACTOR

SCALE: 1/4" = 1'

DISCIPLINE

DRAWING NO.

TITLE NAME:
031124E Rubio Tampa visit

sheet 1 of 1

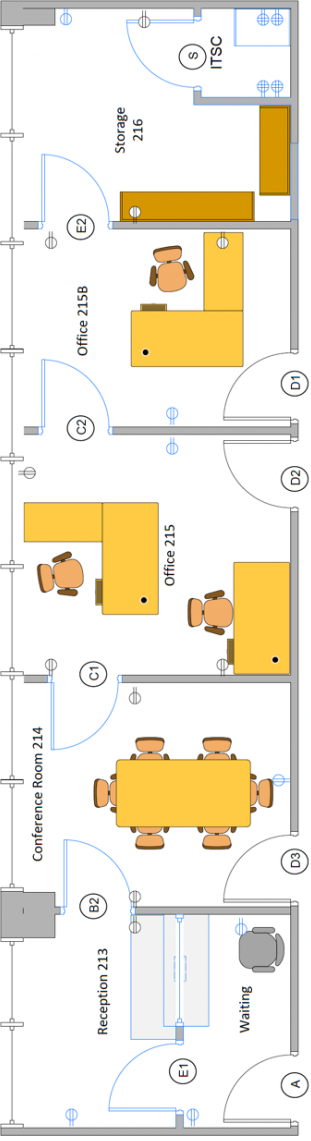

0' 3' 5' 10'

SECURITY DOOR LEGEND

(A)	Main Entrance	(C)	Safe Haven	(E)	Interior Door	(G)	Staff Entrance Gate	(S)	IT / Security Closet
(B)	Staff Entrance	(D)	Perimeter	(F)	Aluminum Framed Glass	(H)	Hercullite		

ELECTRICAL LEGEND

(G)	Quadruplex Receptacle Outlet	(C)	Single Receptacle Clock Outlet
(H)	Single Receptacle Outlet		
(S)	Duplex Receptacle Outlet		